

KEY TYPES - L3

FEATURES AND BENEFITS

To ensure your work tools remain safe and secure, it's important to be able to lock your storage solutions when required. We have several key management options for different scenarios. For example, for ease of use, you may want the same key to open any unit; or perhaps, for extra security, you require different

keys for each unit; or maybe you want different access levels based on seniority. For our L3 lock and key system we have three management types: identical keys (KA), different keys (KD) and a master key system (MK).



FOR ALL PRODUCTS AND COMPONENTS WITH LOCKS, SPECIFY THE TYPE OF KEY REQUIRED: KA, KD OR MK.

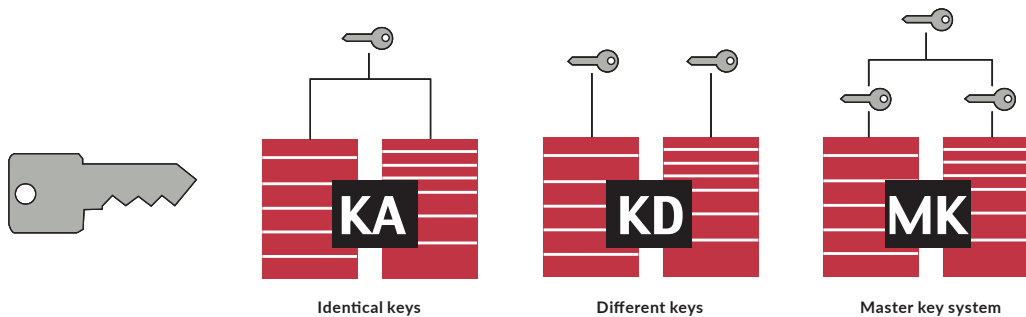

YOU MUST SPECIFY THE TYPE OF KEY REQUIRED FOR THE PRODUCTS BELOW

PRECONFIGURED MODELS

- R Heavy-Duty Stationary Cabinet (R5A)
- R Heavy-Duty Mobile Cabinet (R5B / R5D)
- Stacking Cabinet (R5H)
- Sink Cabinet (R5T)
- L Compact Stationary Cabinet (L3A)
- L Compact Mobile Cabinet (L3B)
- Hanging Side Cabinet (R5Q)
- R Multi-Drawer Stationary Cabinet (R5K)
- R Multi-Drawer Mobile Cabinet (R5G)
- Drawer Unit (LD75 / LD77 / RD77)
- TekZone Hutch (TZ)
- Corner Workstation (RS)
- Wall-Mounted Computer Cabinet and Housing (R5M)
- Computer Cabinet (R5J)
- MultiTek Cart (RV)

COMPONENTS AND ACCESSORIES

- Integrated Sliding Door or with Frame, Solid or Polycarbonate (RB50 / RB51 / RB55 / RB56 / WS60 / WS61)
- Single Integrated Door or with Frame, Solid or Polycarbonate (RB61 / RB62 / RD12 / RD13 / RD51)
- Double Integrated Door or with Frame, Solid or Polycarbonate (RB66 / RB67 / RB75 / RB76 / RD17 / RD18 / SH41 / SH43 / SH91 / SH93)
- Door for L Cabinet (LB30)
- Flipper Door (RD20 / SH85)
- Vertical Security Bar (RB10 / RE80 / LB10)
- Compact Drawer (LF31)
- Cabinet Locking System (L3)
- Heavy-Duty Modular Drawer and Roll-Out Shelf (RF31 / RF32 / RF35 / RF36 / RF40 / RF41 / RF44 / RF45)
- Heavy-Duty Cabinet and Stacking Cabinet Housing (RA30)
- Storage Cabinet (WM75)
- Sloped Top (RC30)
- L Compact Cabinet (LA30)

NOTES: Please contact your customer service representative for questions about the different key types. They will be happy to assist you. All products with a lock need to have a key code, the list above is for reference purposes only.

L50 ELECTRONIC LOCK FOR CABINET WITH DRAWERS

- Electronically locks all drawers in the cabinet at the same time
- No key required
- Up to 20 different users can be programmed
- 4- to 8-digit access codes
- Simplifies access management to drawers

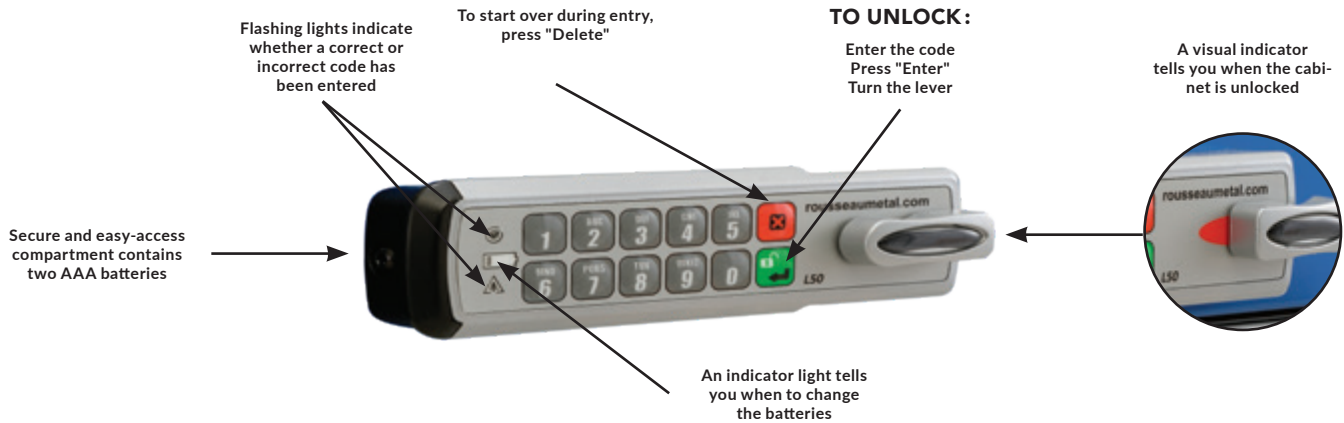

VARIOUS WAYS TO MANAGE ACCESS

"OWNER" USER (UNIQUE CODE)

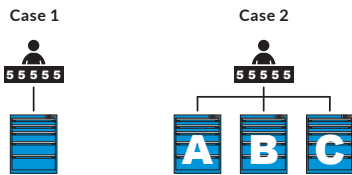

SUPERVISOR (UNIQUE CODE) WITH USERS (SAME CODE)

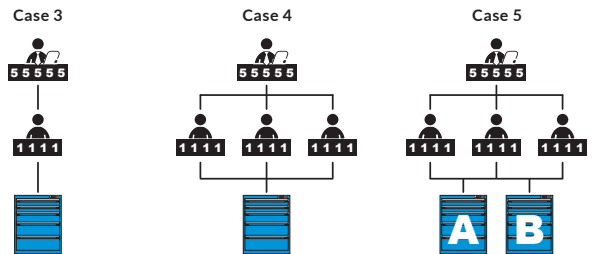

SUPERVISOR (UNIQUE CODE) WITH USERS (DIFFERENT CODES)

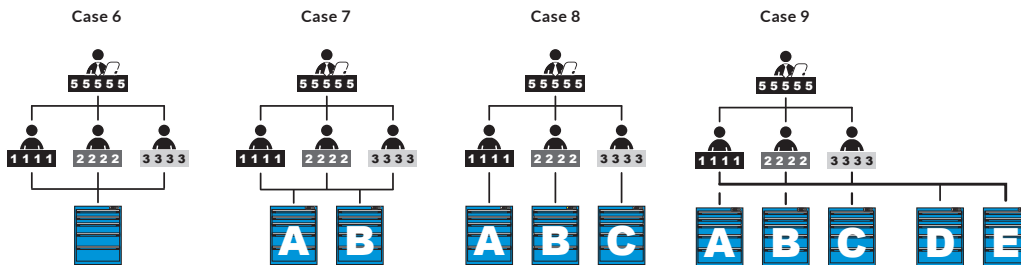

HOW TO ORDER

To order the complete mechanism with a drawer cabinet, order:

- RB00-DD HHL50 for an R cabinet (RA30)
- RB01-WW DD HHL50 for a multi-drawer cabinet (RA35), contact Customer Service
- LB00-DD HHL50 for an L cabinet (LA30)

To order as a replacement lock, order:

- HA62-L50 for an R cabinet with drawers or multi-drawer cabinet (RA30 / RA35)
- HA60-L50 for an L cabinet with drawers (LA30)

NOTE: The L50 Electronic Lock interferes with RB92 front handles. Please contact Customer Service for more details.

KEY TYPES - L50

L50 ELECTRONIC LOCK FOR DOORS

- Electronically locks doors of Rousseau products
- No key required
- Up to 20 different users can be programmed
- 4-8 digit access codes
- Compatible with L, R and SH swing doors, single or double, solid or polycarbonate, with or without frame (LB30, RB61/RB62, RB67/RB66, RD12/RD13, RD17/RD18, RB75/RB76, SH41/SH43, SH91/SH93)
- Compatible with RD20, SH85 and WM76 flipper doors and RH06 pull-down doors
- Not compatible with sliding doors (RB50/RB51, RB55/RB56, WS60/WS61)



VARIOUS WAYS TO MANAGE ACCESS

"OWNER" USER (UNIQUE CODE)

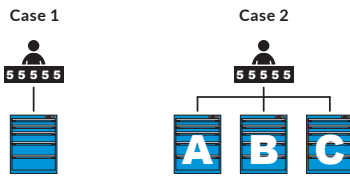

SUPERVISOR (UNIQUE CODE) WITH USERS (SAME CODE)

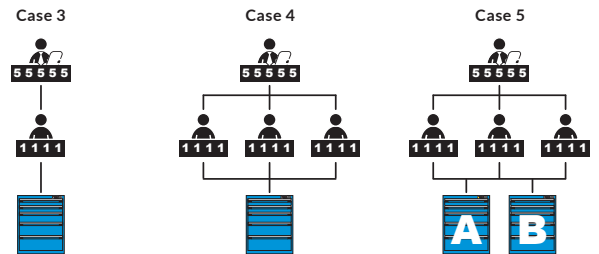

SUPERVISOR (UNIQUE CODE) WITH USERS (DIFFERENT CODES)

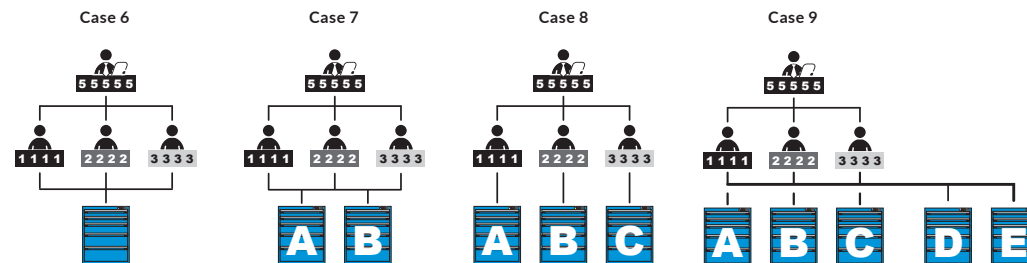

HOW TO ORDER

To order an L50 lock for an existing door:

- RY50-L50 for an RB61/RB62 door
- RY51-L50 for an RB66/RB67 door
- RY52-L50 for an RB75/RB76 door
- RY56-L50 for an RD12/RD13 door
- RY57-L50 for an RD17/RD18 door
- SY50-L50 for an SH door manufactured after March 2019
- RY63-L50 for an RH06 door manufactured before October 2018
- HA72-L50 for an RH06 door manufactured after October 2018

NOTE: Not compatible with SH doors manufactured before March 2019.